



Large Diameter Fittings



Stainless Steel Flow Control Equipment for the Food
and Beverage, Dairy, Cosmetics, Biotechnology,
Pharmaceutical and Electronics Processing Industries

Large Diameter Tubing and Fittings



Top Line offers single source service of quality 6 inch tubing and fittings. All major components are shipped promptly from our plant. Special order 8 inch, 10 inch, 12 inch, and other sizes are also available for unique applications. Call us with your inquiries.

Fitting Specifications

- 304, 304L, 316L
- A269, A774
- Polished, unpolished
- .109" wall thickness (6" & 8")
- .134" wall thickness (10" & 12")
- 6", 8", 10", & 12" O.D.

Tubing Specifications

- 304L, 316L
- A269, A778
- Polished, unpolished
- .109" wall x 20'
- 6", 8", 10", & 12" O.D.

ELBOWS & TEES

LARGE DIAMETER FITTINGS

TOP LINE

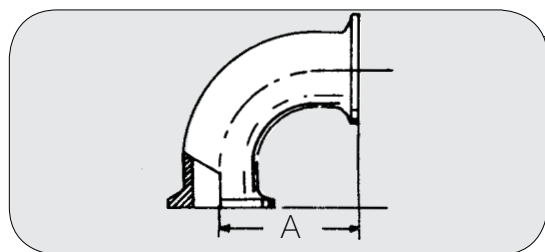

2CMP - 90° ELL

SIZE	A	STOCK NO.
6	9-3/4	32760-7
8	12-7/8	32780-7
10	15-7/8	327100-7
12	19	327120-7

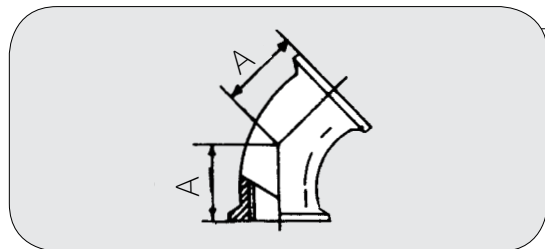

2KMP - 45° ELL

SIZE	A	STOCK NO.
6	4-1/2	32860-7
8	5-7/8	32880-7
10	7-1/8	328100-7
12	8-1/2	328120-7

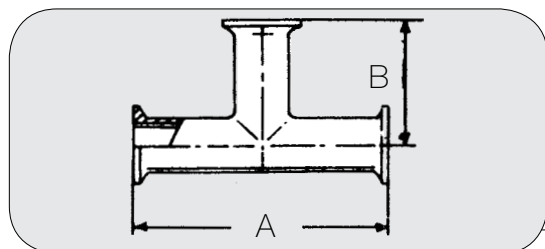

7MP - TEE

SIZE	A	B	STOCK NO.
6	11-1/2	5-3/4	321160-7
8	15-3/4	7-7/8	321180-7
10	18-3/4	10-1/4	3211100-7
12	22	11	3211120-7

7RMP REDUCING TEE

SIZE	A	B	STOCK NO.
6 X 3	11-1/2	5-1/2	321160R30-7
6 X 4	11-1/2	5-5/8	321160R40-7
8 X 3	15-3/4	7-1/2	321180R30-7
8 X 4	15-3/4	7-5/8	321180R40-7
8 X 6	15-3/4	7-3/4	321180R60-7
10 X 3	18-3/4	9	3211100R30-7
10 X 4	18-3/4	9-1/8	3211100R40-7
10 X 6	18-3/4	9-1/4	3211100R60-7
10 X 8	18-3/4	9-3/8	3211100R80-7
12 X 3	22	10-1/2	3211120R30-7
12 X 4	22	10-5/8	3211120R40-7
12 X 6	22	10-3/4	3211120R60-7
12 X 8	22	10-7/8	3211120R80-7
12 X 10	22	10-7/8	3211120R100-7

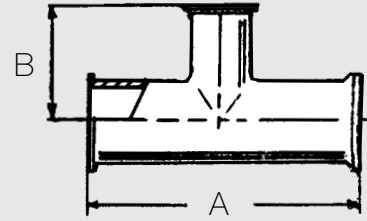

9MP CROSS

SIZE	A	STOCK NO.
6	11-1/2	3210160
8	15-3/4	3210180
10	18-3/4	32101100
12	22	32101120

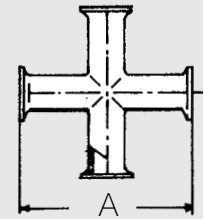

31-14MP CONCENTRIC REDUCER

SIZE	A	STOCK NO.
6 X 3	7-1/2	328460
6 X 4	5-3/8	328460A
8 X 3	7-3/8	328480
8 X 4	7-1/2	328480A
8 X 6	7-5/8	328480B
10 X 6	8-3/4	3284100
10 X 8	8-3/4	3284100A
12 X 8	9-7/8	3284120
12 X 10	9-7/8	3284120A

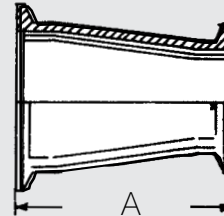

32-14MP ECCENTRIC REDUCER

SIZE	A	STOCK NO.
6 X 3	7-1/2	328560
6 X 4	5-1/2	328560A
8 X 3	7-3/8	328580
8 X 4	7-1/2	328580A
8 X 6	7-5/8	328580B
10 X 6	8-3/4	3285100
10 X 8	8-3/4	3285100A
12 X 8	9-7/8	3285120
12 X 10	9-7/8	3285120A

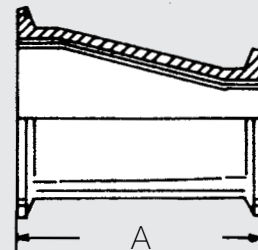

14WMP SHORT WELD FERRULE

SIZE	A	STOCK NO.
6	3/4	32260
8	7/8	32280
10	7/8	322100
12	1	322120



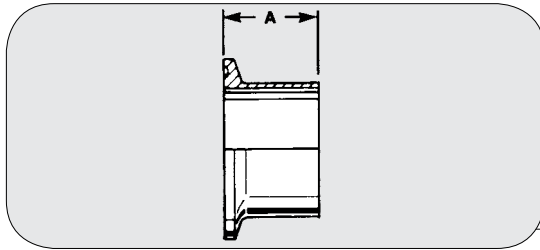

L14AM7 - BUTT WELDING FERRULE

SIZE	A	STOCK NO.
6	1-1/2	327560
8	1-1/2	327580
10	1-1/2	3275100
12	1-1/2	3275120

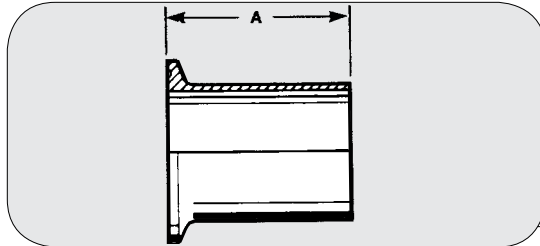

14WLMP - TANK WELDING SPUD-LIGHT

SIZE	A	STOCK NO.
6	6	327760-7
8	6	327780-7
10	6	3277100-7
12	6	3277120-7

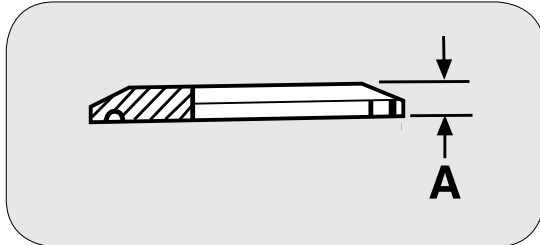

16AMP - SOLID END CAP

SIZE	A	STOCK NO.
6	1/2	329860
8	1/2	329880
10	1/2	3298100
12	1/2	3298120

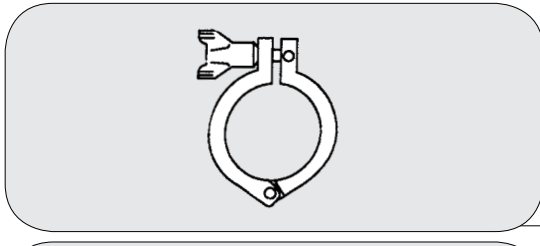

HEAVY DUTY CLAMP

SIZE	13LAH	13MHM	13MHP
6	3299960	N/A	329960HP
8	3299980	329980	N/A
10	N/A	3299100	N/A
12	N/A	3299120	N/A

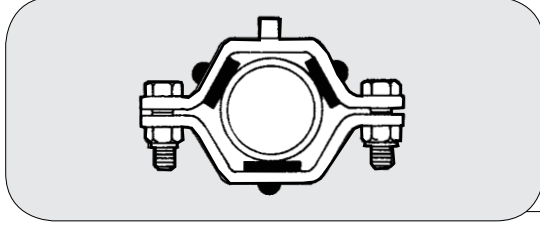

TUBING HANGER

SIZE	B24W	C24T	B24W W/ PP INSERT	C24T W/ PP INSERT
6	32D-60	32C-60	32D-60PP	32C-60PP
8	32D-80	32C-80	32D-80PP	32C-80PP
10	32D-100	32C-100	N/A	N/A
12	32D-120	32C-120	N/A	N/A

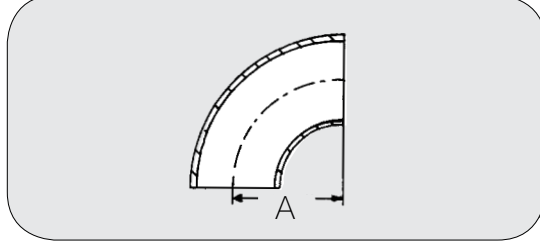

2WCL - 90° WELD ELL

SIZE	A	STOCK NO.
6	9	3530160
8	12	3530180
10	15	35301100
12	18	35301120

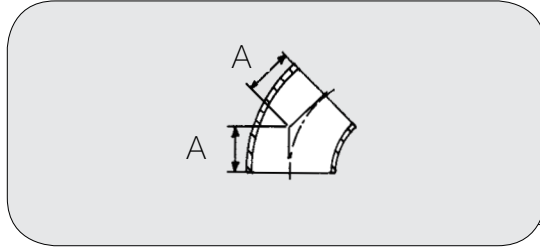

2WK - 45° WELD ELL

SIZE	A	STOCK NO.
6	3-3/4	3530360
8	5	3530380
10	6-1/4	35303100
12	7-1/2	35303120

7W - WELD TEE

SIZE	A	B	STOCK NO.
6	10	5	3530660
8	14	7	3530680
10	17	8-1/2	35306100
12	20	10	35306120

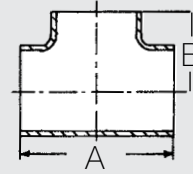

7WR - REDUCING WELD TEE

SIZE	A	B	STOCK NO.
6 X 3	10	5	3530560R-30
6 X 4	10	5	3530560R-40
8 X 3	14	7	3530580R-30
8 X 4	14	7	3530580R-40
8 X 6	14	7	3530580R-60
10 X 3	17	8-1/2	35305100R-30
10 X 4	17	8-1/2	35305100R-40
10 X 6	17	8-1/2	35305100R-60
10 X 8	17	8-1/2	35305100R-80
12 X 3	20	10	35305120R-30
12 X 4	20	10	35305120R-40
12 X 6	20	10	35305120R-60
12 X 8	20	10	35305120R-80
12 X 10	20	10	35305120R-100

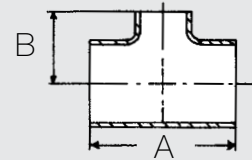

9W - WELD CROSS

SIZE	A	STOCK NO.
6	10	3530460
8	14	3530480
10	17	35304100
12	20	35304120

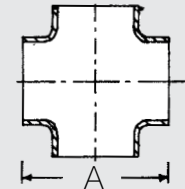

31W - CONCENTRIC WELD REDUCER

SIZE	A	STOCK NO.
6 X 3	6	3530860-30
6 X 4	4	3530860-40
8 X 3	6	3530880-30
8 X 4	6	3530880-40
8 X 6	6	3530880-60
10 X 6	7	35308100-60
10 X 8	7	35308100-80
12 X 8	8	35308120-80
12 X 10	8	35308120-100



32W - ECCENTRIC WELD REDUCER

SIZE	A	STOCK NO.
6 X 3	6	3530960-30
6 X 4	4	3530960-40
8 X 3	6	3530980-30
8 X 4	6	3530980-40
8 X 6	6	3530980-60
10 X 6	7	35309100-60
10 X 8	7	35309100-80
12 X 8	8	35309120-80
12 X 10	8	35309120-100

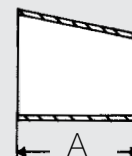

CAPS, STUB ENDS & FLANGES

LARGE DIAMETER FITTINGS



16W - WELD CAP



SIZE	A	STOCK
6	2	3531660S
8	2-1/2	3531680
10	3	35316100
12	-	-

14VB - STUB END

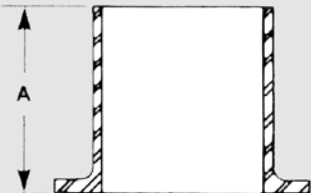

SIZE	A	STOCK
6	3	3530760LS
8	3	3530780LS
10	3-1/2	35307100LS
12	3	35307120LS

38SL - BACK-UP FLANGE

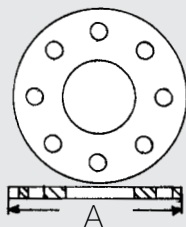

SIZE	A	STOCK
6	11	355-6
8	13	355-8
10	16	355-10
12	19	355-12

TOP LINE

PROCESS EQUIPMENT COMPANY

... the source for
all your product needs
in the process industries

Contact your Top Line Representative for Assistance

Office: P.O. Box 264 · Bradford, PA 16701

Plant: 21 Valley Hunt Drive · Lewis Run, PA 16738

800-458-6095

814-362-4626

Fax: 814-362-4453

PUMPS & STRAINERS- Centrifugal, Rotary Lobe, Filters and Strainers



VALVES - Manual, Actuated, Diaphragm



FITTINGS - Clamp, Sanitary Butt Weld, Bevel Seat, Tube OD Butt weld, Custom, Biopharm



TUBING, GAUGES, SIGHT GLASSES, BRAIDED HOSE

